



DIN
DIN 11 851

DIN

DIN 11 851

MATERIAL MATIÈRE MATERIAL

 SS = Stainless steel Inox

SIZE DIMENSIONS DIMENSIONES

From DN 25 to 150 mm

THREAD FILETAGE ROSCA

DIN 405

MALE PART NEZ FILETÉ

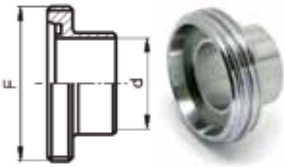

DN	F	d
10	28x1/8"	10
15	34x1/8"	16
20	44x1/6"	20
25	52x1/6"	26
32	58x1/6"	32
40	65x1/6"	38
50	78x1/6"	50
65	95x1/6"	66
80	110x1/4"	81
100	130x1/4"	100
125	160x1/4"	125
150	190x1/4"	150

FEMALE PART PIÈCE LISSE

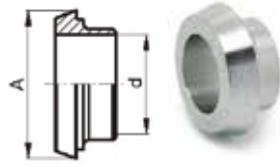

A	d
22	10
28	16
36	20
44	26
50	32
56	38
68	50
86	66
100	81
121	100
150	125
176	150

NUT ECROU



F	A	L
28x1/8"	38	18
34x1/8"	44	18
44x1/6"	54	21
52x1/6"	63	21
58x1/6"	70	21
65x1/6"	78	21
78x1/6"	92	22
95x1/6"	112	25
110x1/4"	127	30
130x1/4"	148	31
160x1/4"	178	35
190x1/4"	210	40

GASKET JOINT DE RACCORD

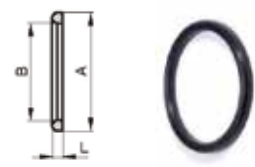

A	B	L
20	12	4,5
26	18	4,5
33	23	4,5
40	30	5
46	36	5
52	42	5
64	54	5
81	71	5
95	85	5
114	104	6
142	130	7
167	155	7

DIN

ØB

Mâle

Femelle

ØA

4 encoches Ø19 à 50
6 encoches Ø65 à 125

DIN	ØA	ØB
19	36,5	44 6F"
25	44	52 6F"
32	50	58 6F"
40	56	65 6F"
50	68	78 6F"
65	86	95 6F"
80	100	110 4F"
100	121	130 4F"
125	132	160 4F"

AL = Aluminium BR = Brass Laiton Latón ST = Steel Acier Acero SS = Stainless steel Inox PP = Polypropylene

Trelleborg Fittings

		ID coupling Diam. raccord Diam. racor	ID shank Diam. douille Diam. espiga	Ref.	Notes
 <p>Female. Serrated hose shank. For circlip. Femelle. Douille crantée. Pour jonc. <i>Hembra. Caña acanalada. Para anillo.</i></p>	<p>PAGE 99. Circlip and ferrule. Jupe et jonc. <i>Junta y anillo.</i></p>	SS 316L	25	25	011 69 88
			32	32	510 02 89
			40	38	011 69 36
			50	51	011 67 37
			65	63	011 69 12
			80	76	011 69 15
			100	101,5	011 70 16
			125	125	510 03 15
			150	150	510 09 41
 <p>Male. Serrated hose shank. For circlip. Mâle. Douille crantée. Pour jonc. <i>Macho. Caña acanalada. Para anillo.</i></p>	<p>PAGE 99. Circlip and ferrule. Jupe et jonc. <i>Junta y anillo.</i></p>	SS 316L	25	25	011 69 89
			32	32	510 02 88
			40	38	011 69 35
			50	51	011 67 38
			65	63	011 69 11
			80	76	011 69 14
			100	101,5	011 70 15
 <p>Nut. Ecrou. <i>Tuerca.</i></p>		SS 304	25		011 69 85
			32		510 02 87
			40		011 69 34
			50		011 67 39
			65		011 69 10
			80		011 69 13
			100		011 70 12
			125		510 03 13
150		510 09 43			
 <p>Gasket. For male DIN. Joint. Pour mâle DIN. <i>Junta. Para macho DIN.</i></p>		EPDM	25		510 23 30
			32		510 23 31
			40		510 23 32
			50		510 18 03
			65		510 23 33
			80		510 23 34
			100		510 23 35
			125		510 23 36
			150		510 20 66

■ AL = Aluminium
 ■ BR = Brass *Laiton Latón*
 ■ ST = Steel *Acier Acero*
 ■ SS = Stainless steel *Inox*
 ■ PP = Polypropylene

Trelleborg Fittings

		SS 304	ID coupling	ID shank	Ref.	Notes
			Diam. raccord Diam. racor	Diam. douille Diam. espiga		
	Spanner. Clé de serrage. <i>Llave de presion.</i>				510 15 43	
	Female. Serrated hose shank. With collar. Femelle. Douille crantée. A collerette. <i>Hembra. Caña acanalada. Con cuello.</i>	SS 316L	25	25	510 20 37	
			40	38	510 18 39	
			50	51	510 18 40	
			65	63	510 18 41	
			80	76	510 18 42	
			100	101,5	510 18 43	
	Male. Serrated hose shank. With collar. Mâle. Douille crantée. A collerette. <i>Macho. Caña acanalada. Con cuello.</i>	SS 316L	40	38	510 18 44	
			50	51	510 18 45	
			65	63	510 18 46	
			80	76	510 18 47	
			100	101,5	510 18 68	
	Female. Smooth shank. With collar. Femelle. Douille lisse. A collerette. <i>Hembra. Caña lisa. Con cuello.</i>	SS 316L	40	38	010 01 32	
			50	50,5	510 00 70	
			65	63	510 02 23	
	Male. Smooth shank. With collar. Mâle. Douille lisse. A collerette. <i>Macho. Caña lisa. Con cuello.</i>	SS 316L	40	38	510 02 69	
			50	50,5	510 07 00	
			65	63	510 18 50	
	Female for welding. Femelle à souder. <i>Hembra para soldar.</i>	SS 316L	80	75	510 02 24	
			40	38	510 02 69	
			50	50,5	510 07 00	
			65	63	510 18 50	
			80	75	510 18 51	
	Male for welding. Mâle à souder. <i>Macho para soldar.</i>	SS 316L	25	28	510 20 54	
			32	34	510 20 55	
			40	40	510 20 56	
			50	52	510 20 57	
			65	70	510 20 58	
			80	85	510 20 59	
	Male for welding. Mâle à souder. <i>Macho para soldar.</i>	SS 316L	100	104	510 20 60	
			25	28	510 23 37	
			32	34	510 23 38	
			40	40	510 23 39	
			50	52	510 23 40	
			65	70	510 23 41	
			80	85	510 23 42	
			100	104	510 23 43	